



CURRY COUNTY COMMUNITY DEVELOPMENT BUILDING DIVISION

COURTHOUSE ANNEX • 94235 MOORE STREET, SUITE 113 • GOLD BEACH, OREGON 97444

Marc Bangma
Building Official

Phone (541) 247-3304
FAX (541) 247-4579

SHED

What is the maximum height and square footage to build a shed without a structural permit?

2017 Oregon Residential Specialty Code
Work exempt from permit

R105.2.1 Nonhabitable one-story detached accessory structures, provided that the floor area does not exceed 200 square feet and a wall height of 10 feet measured from the finished floor level to the top of the top plate.

Exception: Where the structure is located on a parcel of 2.0 acres or greater in area, and the structure is located a minimum of 20 feet from all property lines, floor area may be increased to 400 square feet.

R105.2.15 Porches and decks, where the floor or deck is not more than 30 inches above adjacent grade measured at any point within 3 feet horizontally of the floor or deck, and where in the case of a covered porch, the covered portion of the porch does not come closer than 3 feet to property lines.

A permit is required if **A** is greater than 30" (R105.2.15) or **B** is greater than 10' (R105.2.1)

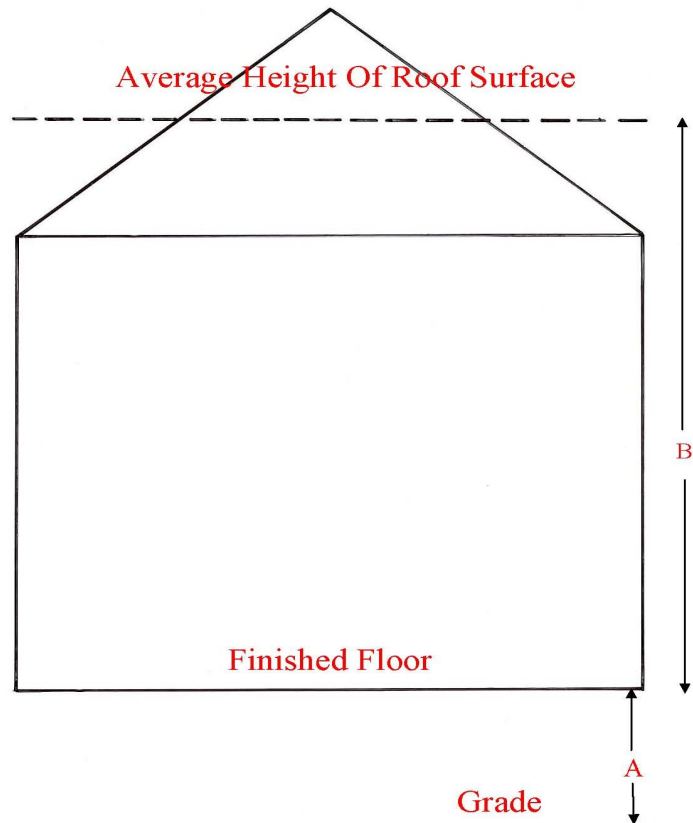

Submission of a Planning Clearance Application is required for placement approval.